

Globally Replace Mate Reference

SOLIDWORKS 2016 allows designers to replace a missing mate reference whenever a mate loses its reference due to geometry changes.

For example many, designers may need to delete sketch entities which renumber the internal face definition of the models. This modification to the underlying sketch geometry and subsequent renumbering of the face ID will cause mates references to fail or become missing when a parent assembly recalculates the mates. Suppressing or Unsuppressing features within a model may also cause a Mate Reference to fail.

If a Mate Reference is missing from a component that is used in many places in an assembly, you can replace the missing reference for all instances at the same time.

To use the **Replace Mate Entities** feature, select the mate with the error and then select the **Replace Mate Entities** icon. Find the missing reference in the **Mated Entities** FeatureManager, select a suitable replacement entity and select the green checkmark to complete the replacement.

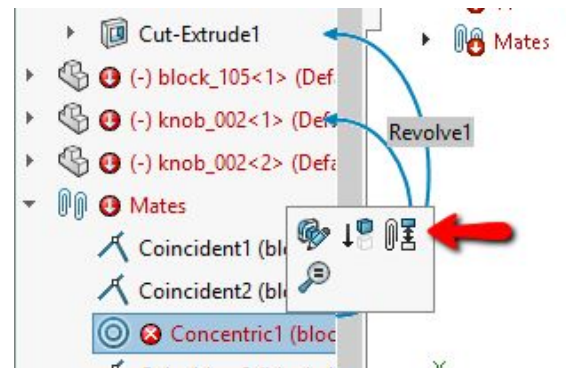

After replacing the Mate Reference for one of the many affected mates, a dialog box offers the option to replace it in all other mates with the same missing reference. In SOLIDWORKS 2015 and older you would have had to replace the Mate Reference for each instance of the component.

